

**SECTION**

**S**

**Supplement No. 1**

**SERVICING THE**

**DISC BRAKES**

## DISC BRAKES

### Removal and Disassembly

(Refer to Figure S-1)

1. Loosen the rear wheel lug bolts.
2. Block up the tractor and remove the rear wheels.
3. Remove cotter pin (27), with washer (26) from brake rod (25).
4. Remove cotter pin (22), clevis pin (24) brake rod (25) and clevis (23).
5. Remove cotter pin (17), clevis pin (18), cotter pin with washer (9) and pull rod (11).
6. Remove the right hand brake assembly cotter pins and washers (31) from point A and also from the right hand brake assembly cam (30). Remove pull strap (29), Inset A.
7. Remove roll pin (20), lever (21) and brake shaft (19).
8. Remove four bolts (2) securing the brake assemblies to the axle housings and lift off the brake assemblies.

**NOTE** Both the right and left brake assemblies are identical and are disassembled in the same manner.

9. Remove nuts (14), bolts (1) and lift off the carrier (3), shims (4) and spacers (5).

**NOTE** The brake linings are riveted to the carriers and should be replaced as an assembly when required.

10. Remove snap ring (16), spring (15), cam actuator (13), cam (10), shims (8), brake bracket (7) and carrier (6).

**IMPORTANT** Shims (4 and 8) may or may not be used. It is important that an equal amount be used at each location.

### Assembly

1. Assemble the brake assemblies (1 thru 16) being sure that shims (4 and 8) are equal and secure to the axle housings with four bolts (2).
2. Install the brake shaft (19), lever (21) and roll pin (20).
3. Install right brake assembly pull strap (29) with cotter pins and washers (31) at point A and the right brake assembly cam (30), inset A.
4. Position pull rod (11) and install washer and cotter pin (9), clevis (12) clevis pin (18) and cotter pin (17).
5. Position brake rod (25), clevis (23) clevis pin (24) and cotter pin (22).
6. Install washer (26) and cotter pin (27).
7. Check the brake adjustment and turn clevis (23) on or off the rod as required. The brake lock (28) should position no lower than the sixth tooth on the brake pedal nor higher than the fourth.
8. Turn the clevis (12) on or off the pull rod (11) until both the right and left brake linings contact the disc simultaneously.
9. Position the rear wheels and install the lug bolts.
10. Remove the blocks and lower the tractor. Torque the lug bolts to 90 ft. lbs.



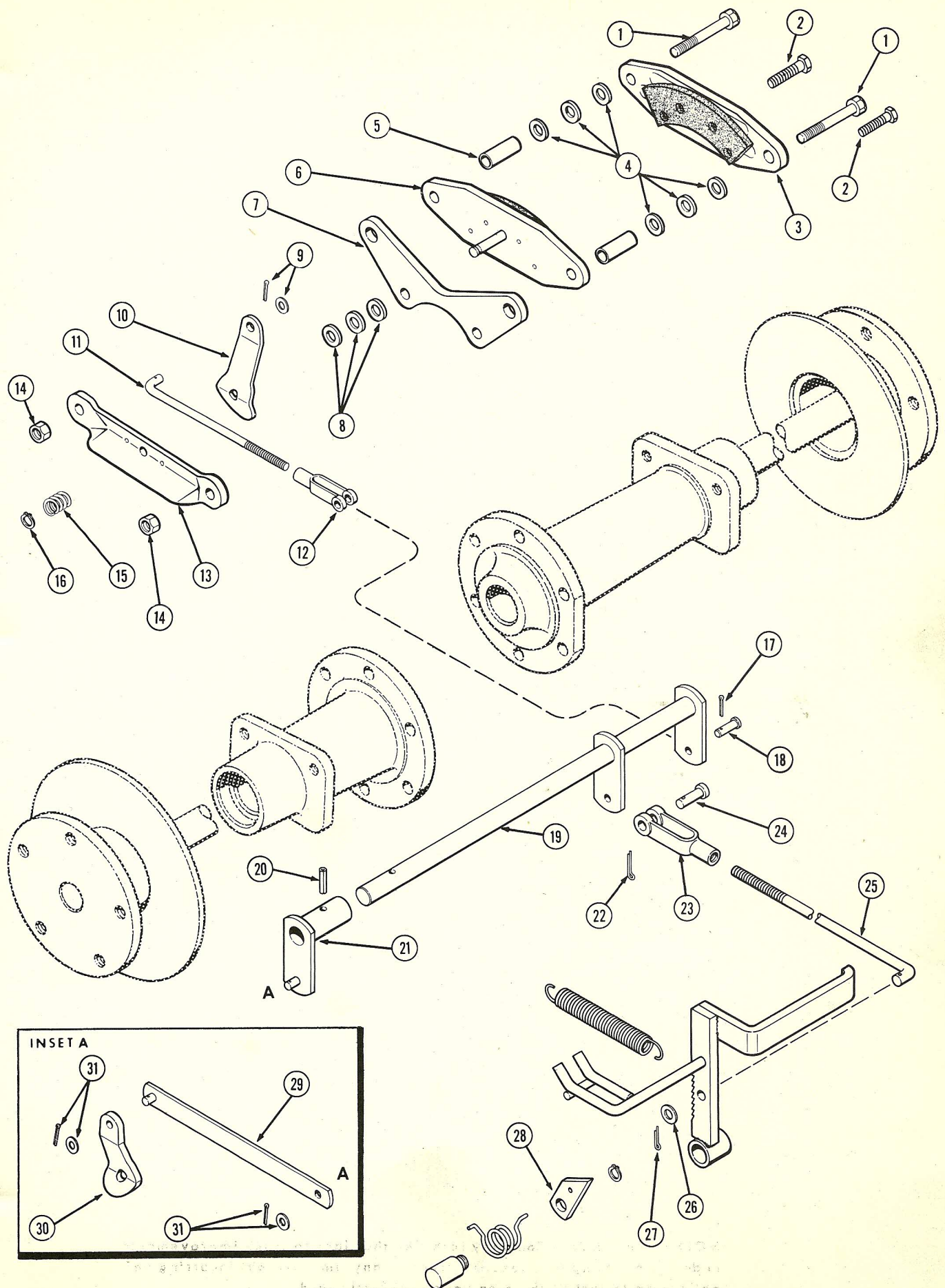

Figure S-1

**NOTE** The J. I. Case Company reserves the right to make improvements in design or changes in specifications at any time without incurring any obligation to install them on units previously sold.