

INDEX

HFC34A FLOW CONTROL VALVE KIT

(Use with HP31 or HP41 PTO)

3000 and 4000 series tractors pin 14145700 to 14180000

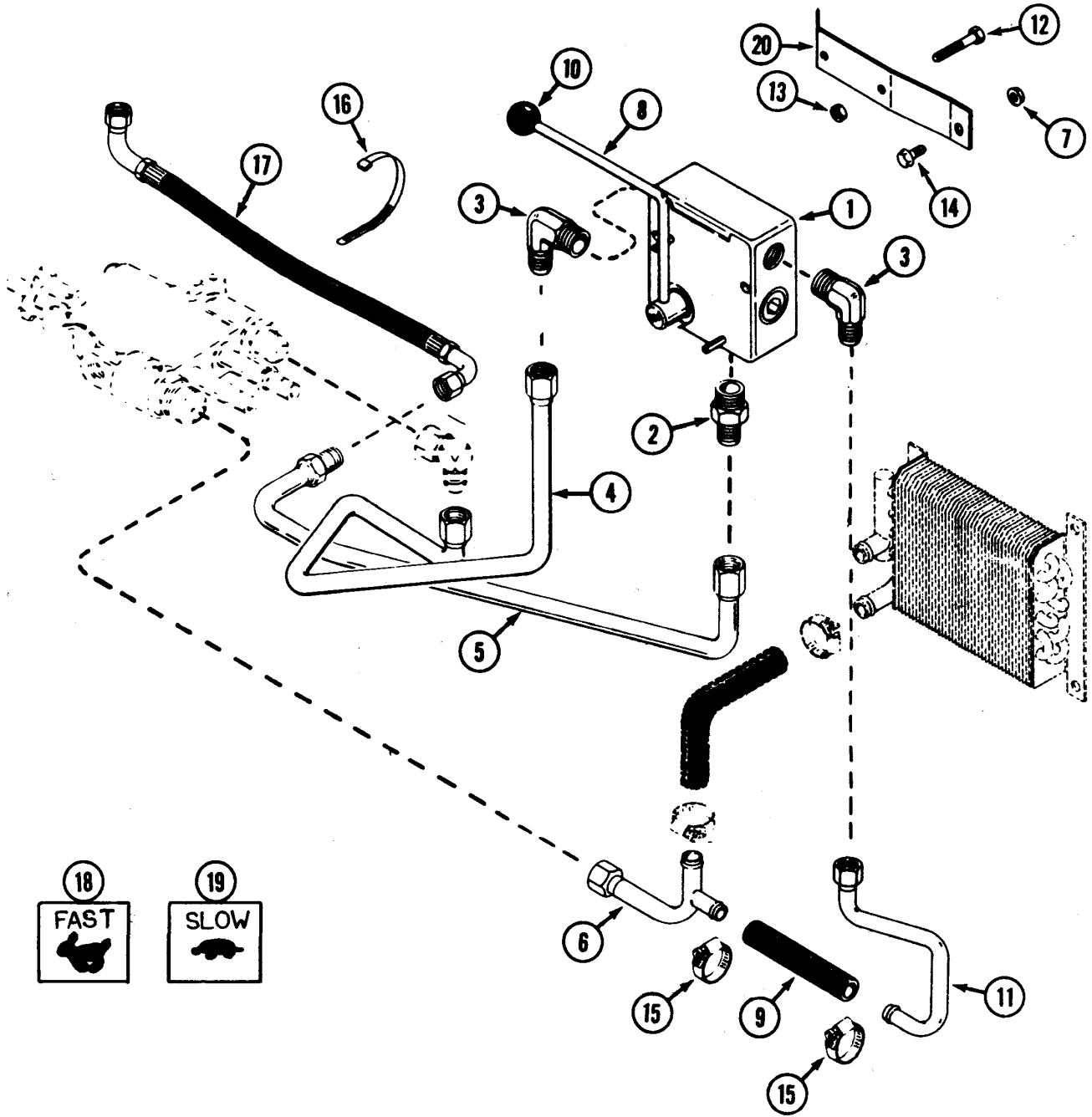

INDEX**HFC34A FLOW CONTROL VALVE KIT**

(Use with HP31 or HP4I PTO)

3000 and 4000 series tractors pin 14145700 to 14180000

REF.	PART NO.	DESCRIPTION	REQ'D
1	C23618	VALVE - flow control.....	1
2	218-445	FITTING - 5/8" x 7/8" - 14	1
3	218-485	FITTING - 5/8" x 7/8" - 14 90° elbow	1
4	C36844	TUBE - flow valve to travel valve	1
5	C36845	TUBE - flow valve to PTO valve	1
6	C36846	TUBE - travel valve to heat exchanger	1
7	131-934	NUT - 1/4" - 20.....	2
8	C36848	LEVER - valve	1
9	C36849	HOSE - rubber 5/8" I.D	1
10	C28251	KNOB - lever	1
11	C36850	TUBE - flow valve to return.....	1
12	113-15	BOLT - 1/4" - 20 x 2-1/4"	2
13	131-1180	NUT - 1/4" - 20 lock	2
14	121-21	BOLT - 1/4" - 20 x 1/2" flange lock	3
15	214-254	CLAMP - hose #12 5/8" to 1-1/4"	4
16	C22947	TIE - nylon	2
17	C33010	HOSE - flow valve to PTO (for 3012, 3014, 3016)	1
17	C33011	HOSE - flow valve to PTO (for 4016)	1
18	C33220	DECAL - "fast"	1
19	C33219	DECAL - "slow"	1
20	C36853	BRACKET - mounting.....	1
	C33221	TRIM - panel (not shown)	1
	218-5229	FITTING 90° swivel elbow (for 3 point hitch connections) not shown	2